

SAIKAWA

COPPER WIRE
DRAWING MACHINE



ごあいさつ

当社は明治43年(1910年)創業以来85年を営みし、産業機械特に塑性加工機の専門メーカーとして又製缶分野では地域の発展と共に歩み皆様方のお引立と先人の努力に依り、今日に至り、その間いささかなりと業界の発展に貢献させていただいたものと自負いたしておる次第でご座います。

私共は伝統から蓄積した技術に加えて積極的な未来を先取りする技術の向上を図り、業界発展へのお手伝いに専心致し、皆様とともに共榮させていただきますならば、これにすぐるものはないものと私を始め社員一同念願している次第でご座います。

何卒皆様方の倍田のお引立とご指導をたまわりますようお願い申し上げます。

取締役社長 西川正男



Greetings

85 years have passed since Saikawa Co., Ltd. was established in 1910. Because of your kind and sincere patronage and continuous efforts made by our elder people, we are here today as a specialized manufacturer of wire making machines. During these 85 years we are convinced of our contribution to the development of our neighbouring community and also the prosperity of the relative industries. With our positive attitude for developing more advanced technology together with the one accumulated in the past, our motto is to help our industries to be more prosperous and accordingly to enjoy the prosperity together with you

We wish and solicit your further unlimited patronage, advice and encouragement.

We remain,

Yours very truly,

Masao Saikawa

President Masao Saikawa

Rod Break Down Drawing Machine

Model	供給線径 Inlet Wire φ m/m	仕上り線径 Finished Wire φ m/m	伸線速度 Drawing Speed Max. m/min.	巻取線径 Wire Dia. φ m/m	巻取速度 Winding Speed Max. m/min.
LLA-13V	9.5 - 8.0	3.2 - 1.2	1,500 (5,000rpm)		
D-250				3.2 - 1.6	1,500 (5,000rpm)

Drawer, Annealer, Vertical Dead Coiler

LLA-13V

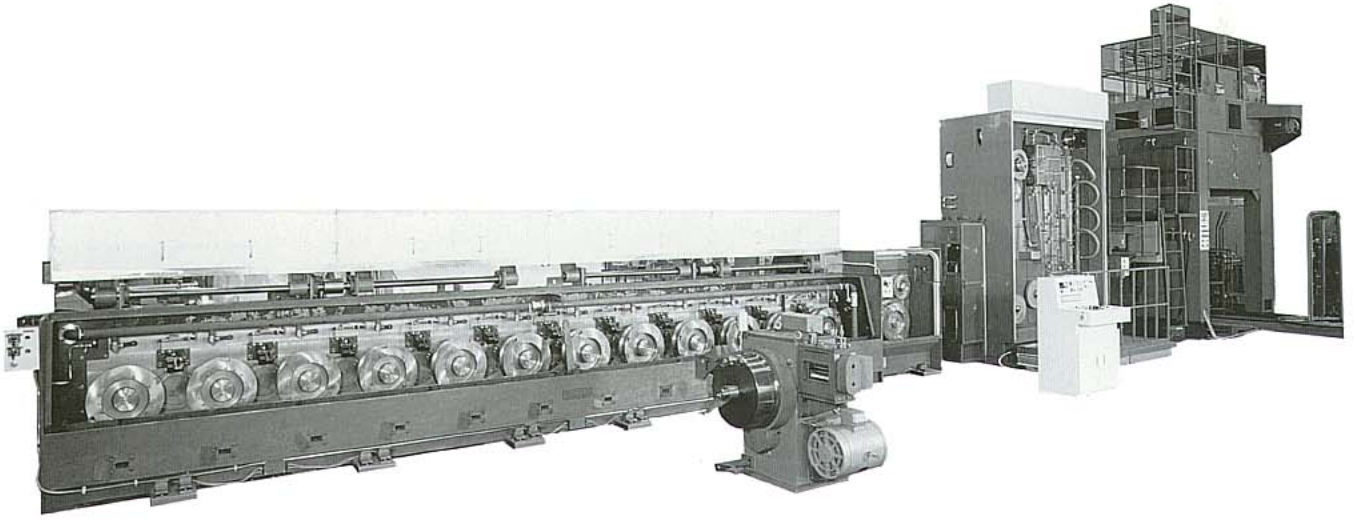

L1950×W8400×H5200

Dual Take-up Spoolers

D-250

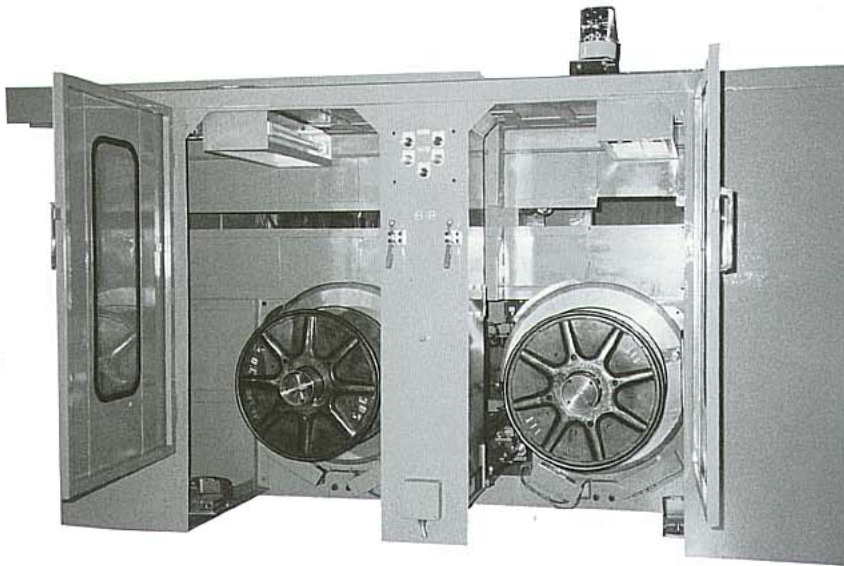

L3200×W2800×H2000

Model	焼鈍線径 Wire Dia. φ m/m	焼鈍速度 Annealing Speed Max. m/min.	巻取線径 Wire Dia. φ m/m	巻取速度 Coiling Speed Max. m/min.
A-2	3.2 - 1.6	1,500 (5,000rpm)		
VD-90			3.2 - 1.6	1,500 (5,000rpm)

Continuous Resistance Annealer
A-2

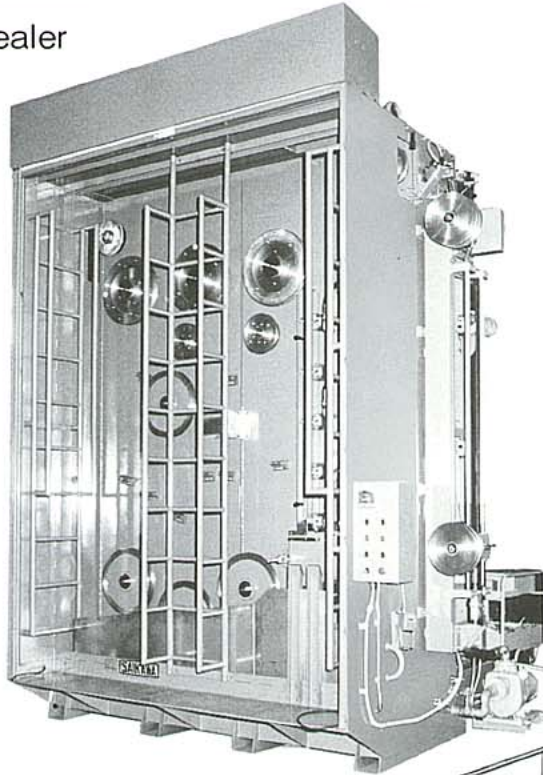

L3900×W2200×H4100

Vertical Dead Coiler
VD-90

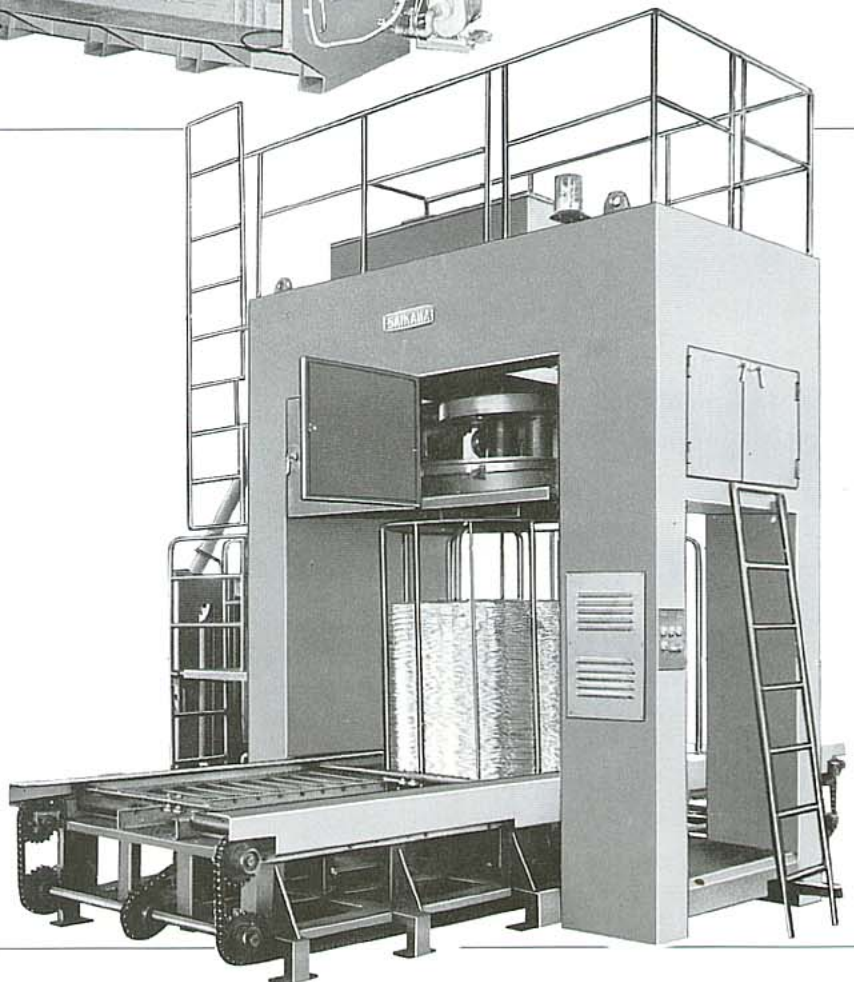

L3500×W5500×W4500

Medium Drawing Machine

Model	供給線径 Inlet Wire φ m/m	仕上り線径 Finished Wire φ m/m	伸線速度 Drawing Speed Max. m/min.
LA-17D	3.2-2.0	1.2-0.32	2,000 (6,600fpm)
L-24	3.2-2.6	0.5-0.18	2,000 (6,600fpm)

Wire Drawing Line Drawer, Annealer, Dual Spooler

LA-17D

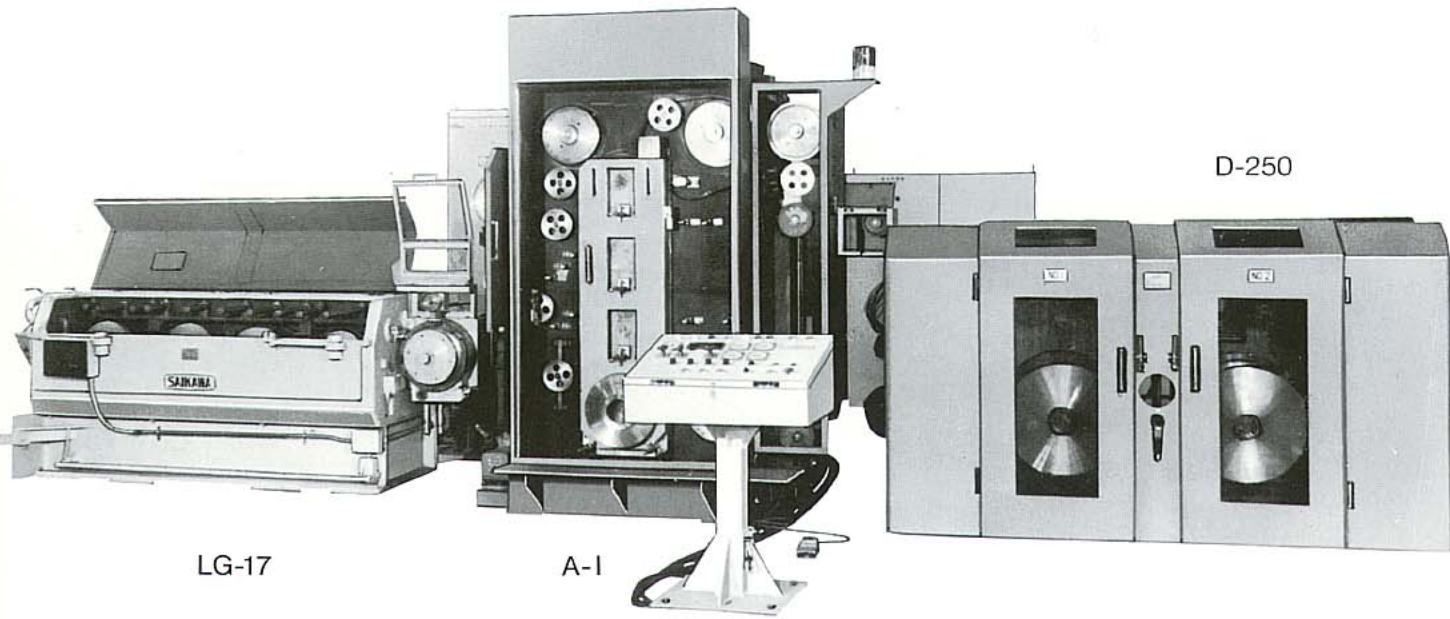

LG-17

A-1

D-250

L10000×W3000×H3000

Drawing Machine

L-24

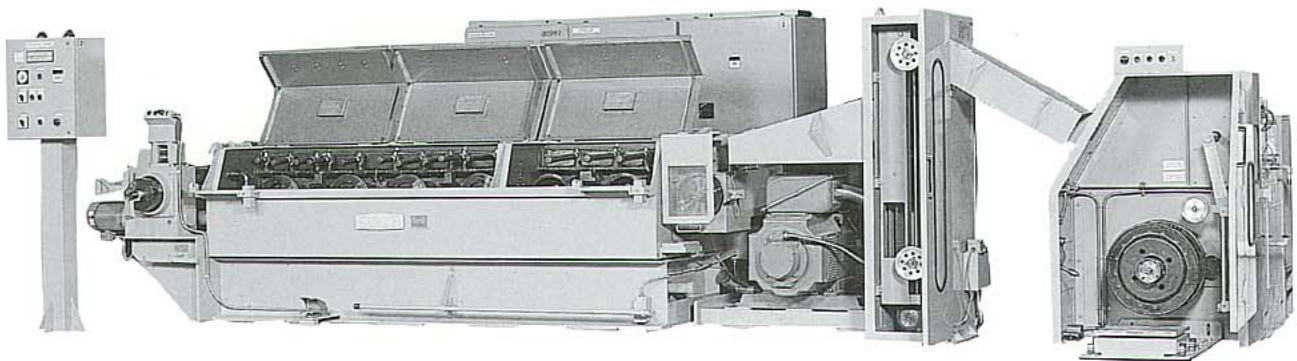

L7500×W2400×H1750

Model	供給線径 Inlet Wire φ/m/m	仕上り線径 Finished Wire φ/m/m	伸線速度 Drawing Speed Max. m/min. (4,000rpm)
L-13V	3.2 - 2.6	1.2 - 0.6	1,200 (4,000rpm)

Wire Drawing Line Drawer, Vertical Dead Coiler

L-13V

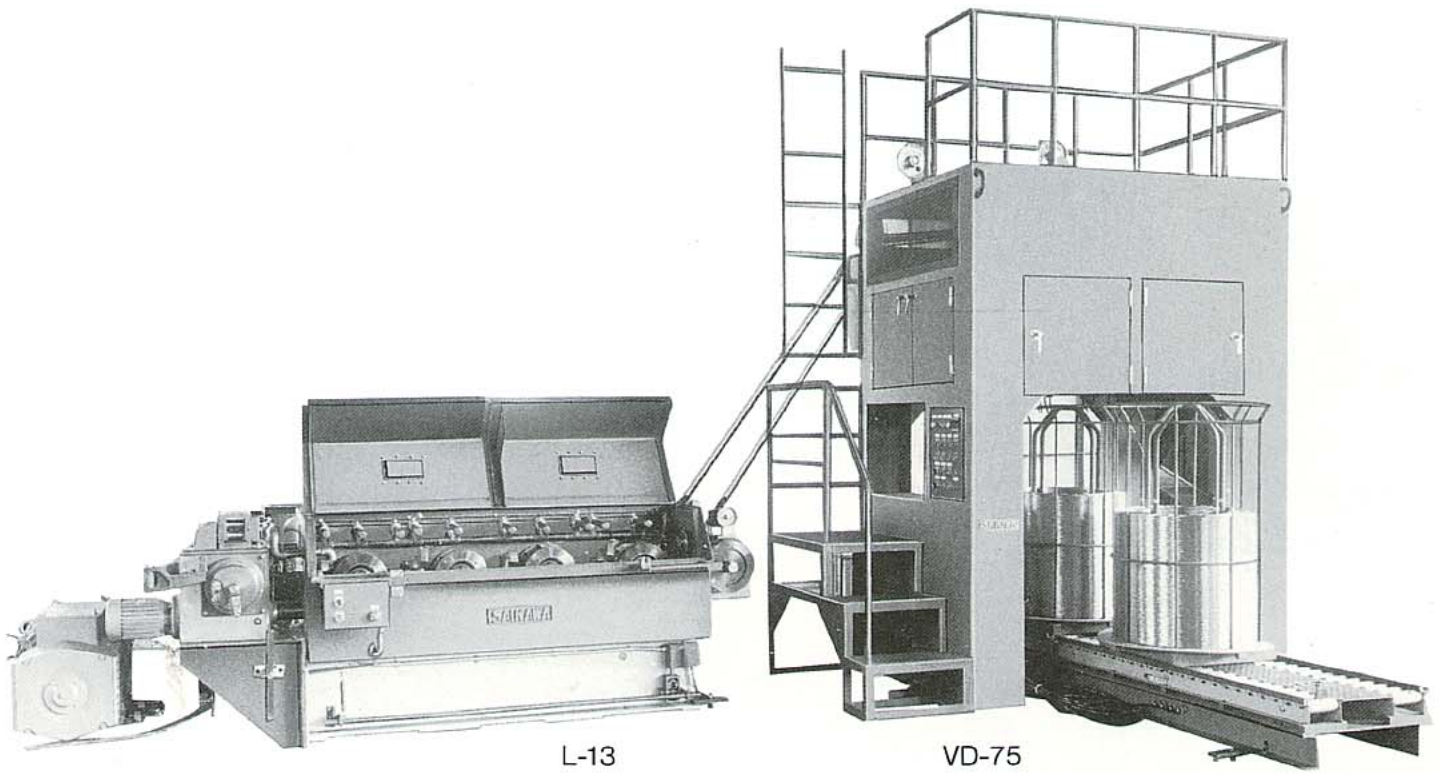

L-13

VD-75

L 6800 × W 8600 × H 3900

Fine Drawing Machine

Model	供給線径 Inlet Wire φ m/m	仕上り線径 Finished Wire φ m/m	伸張速度 Drawing Speed Max. m/min.
M-22C (M-22CJ)	1.2	0.32 - 0.16	2,000 (6,600rpm)
MAP-22J	1.2 - 0.6	0.32 - 0.12	

Fine Wire Drawing Machine

M-22C (M-22CJ)

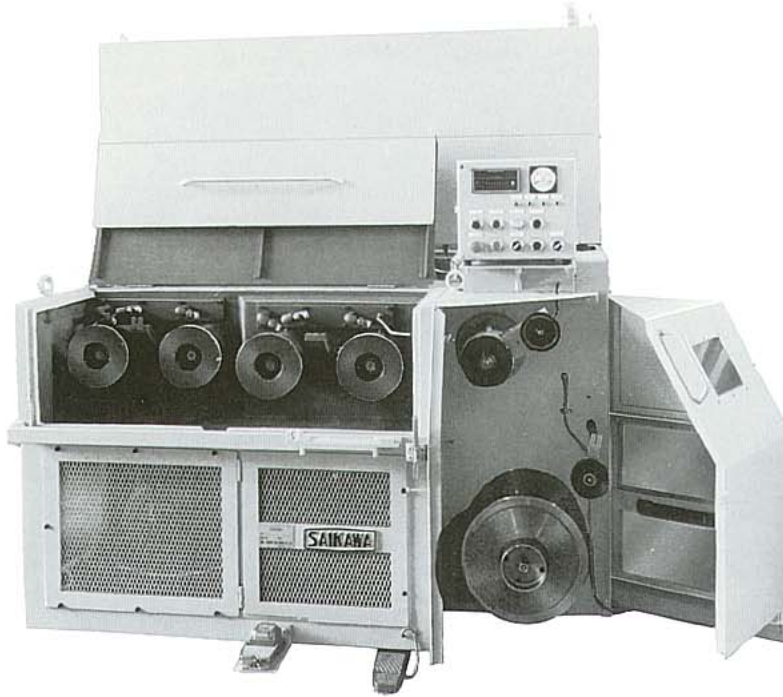

L2500×W1900×H1800

Wire Drawing Line Drawer Annealer Tinning Plant
and Automatic Bobbin Exchanger

MAP-22J

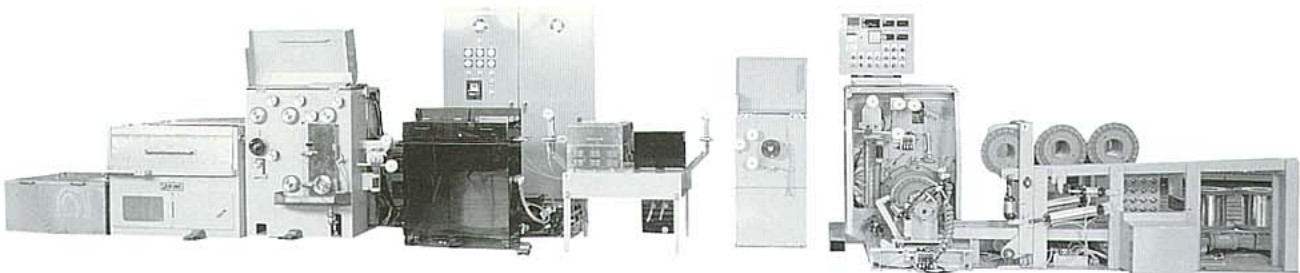

L13000×W3000×H2000

Model	供給線径 Inlet Wire ϕ m/m	仕上り線径 Finished Wire ϕ m/m	伸線速度 Drawing Speed Max. m/min.
MA-22V	1.0 - 0.6	0.32 - 0.1	2,000 (6,600fpm)
M-22J	1.0 - 0.6	0.32 - 0.1	2,000 (6,600fpm)

Fine Wire Drawing Machine with Annealer, and Single Spooler

MA-22V

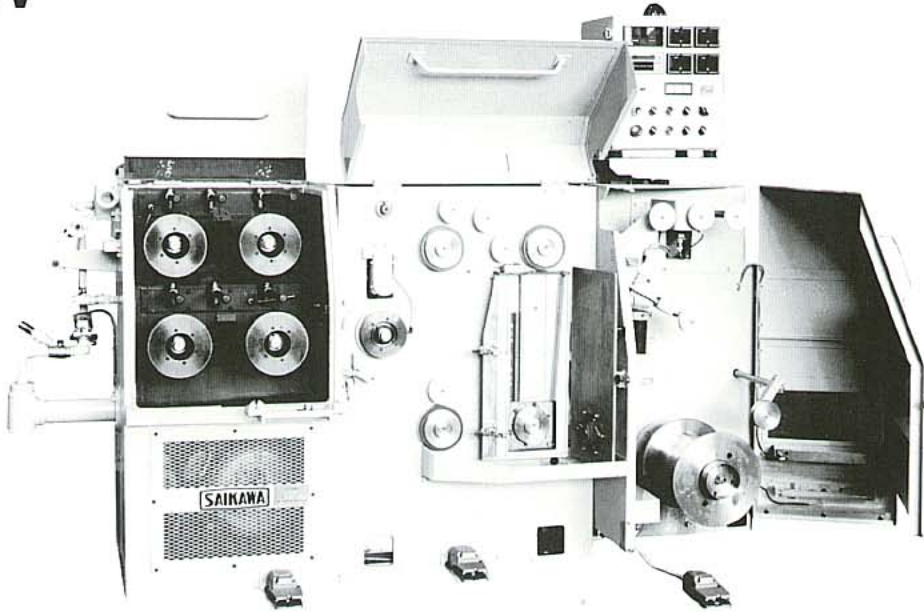

L2800×W1500×H2000

Drawing Machine with Automatic Bobbin Exchanger

M-22J

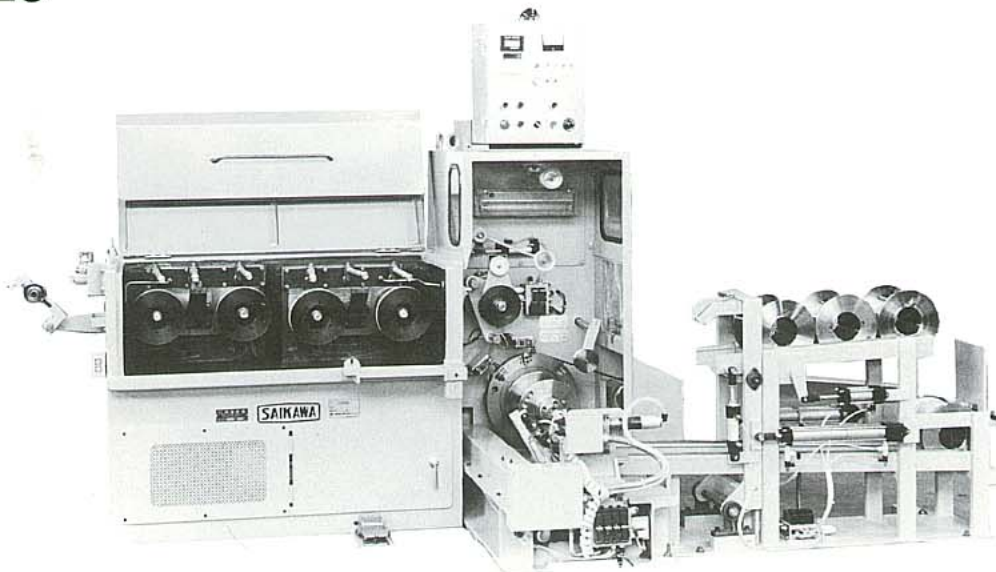

L4000×W2000×H1850

Super Fine Drawing Machine

Model	供給線径 Inlet Wire ϕ m/m	仕上り線径 Finished Wire ϕ m/m	伸線速度 Drawing Speed Max. m/min.
SH-26	0.9 - 0.4	0.12 - 0.05	2,500 (8,300fpm)
S-20	0.4 - 0.18	0.1 - 0.05	2,000 (6,600fpm)

High Speed Drawing Machine

SH-26

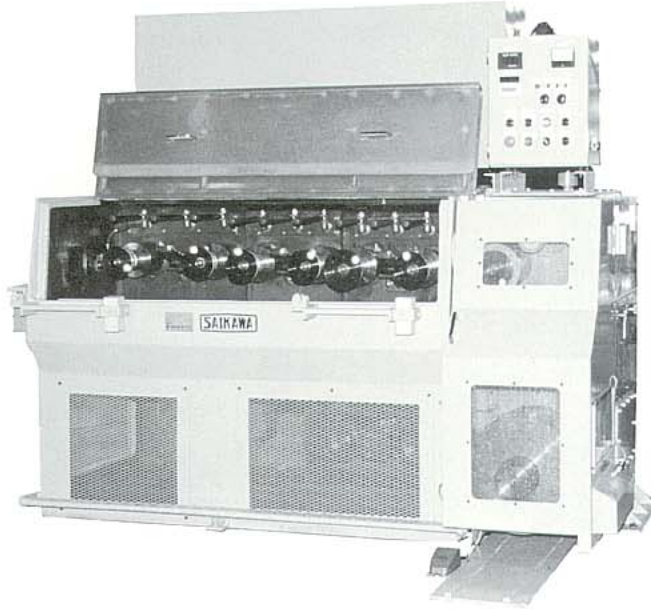

L2500×W1900×H1800

Drawing Machine

S-20

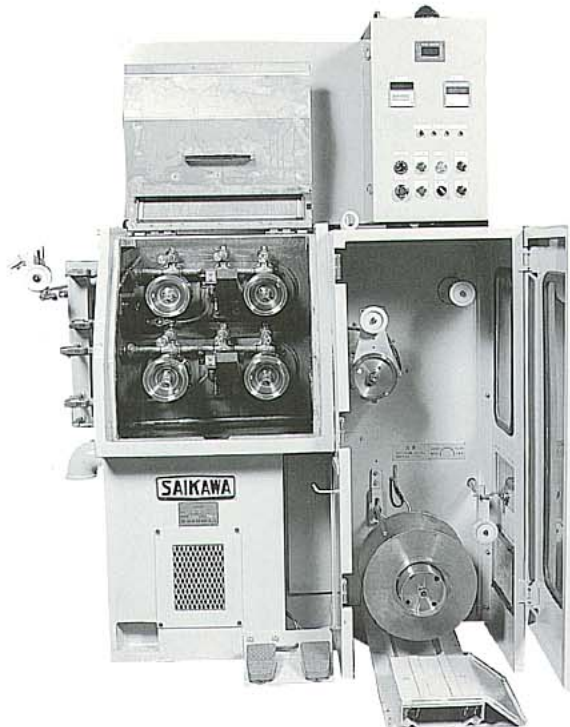

L1600×W1500×H1900

Model	供給線径 Inlet Wire φ/m/m	仕上り線径 Finished Wire φ/m/m	伸線速度 Drawing Speed Max. m/min.
SA-20	0.5 - 0.18	0.12 - 0.05	1,800 (6,000φpm)
SS-20	0.12 - 0.05	0.05 - 0.02	1,500 (5,000φpm)
US-12	0.04 - 0.015	0.025 - 0.01	1,000 (3,300φpm)

Fine Wire Drawing Machine with Annealer and
Single Spooler

SA-20

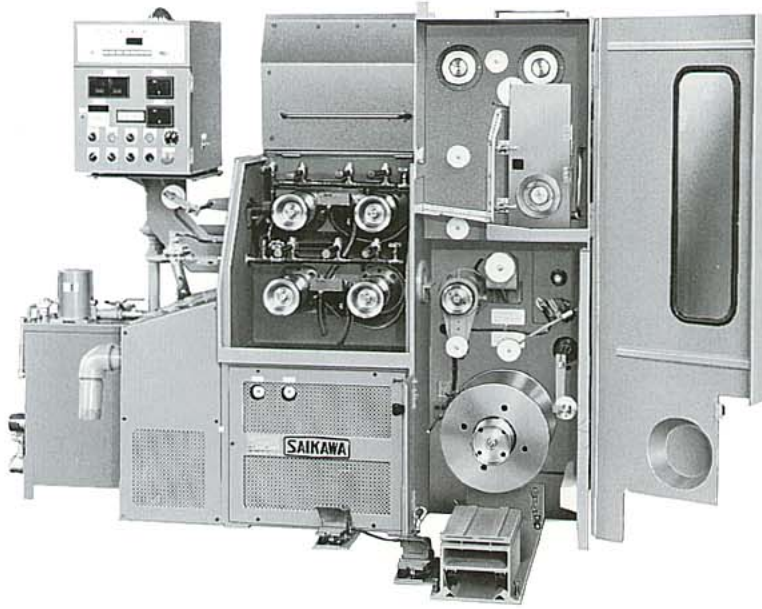

L2750×W1700×H1900

Super Fine Wire
Drawing Machine

SS-20

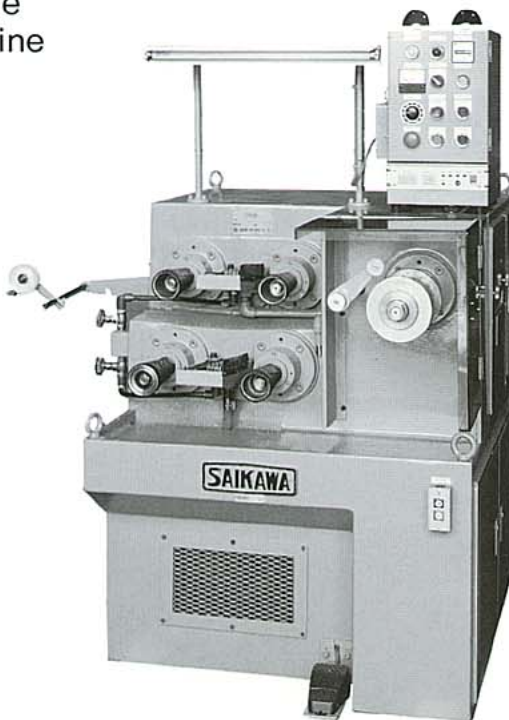

L1250×W1150×H1600

Super Fine Wire Drawing Machine

US-12



L850×W800×H1100

Multi Type Drawing Machine

Model	供給線径 Inlet Wire φ m/m	仕上り線径 Finished Wire φ m/m	伸線速度 Drawing Speed Max. m/min.
ML20×8+A0 ×8+R1500J	2.6	0.45-0.26	1,800
M20×2+AMC ×2+S100×2	0.9-0.6	0.26-0.1	1,800

Multiline 8-Wires Drawing Machine
with Automatic Bobbin Exchanger

**ML20×8+A0×8
+R1500J**

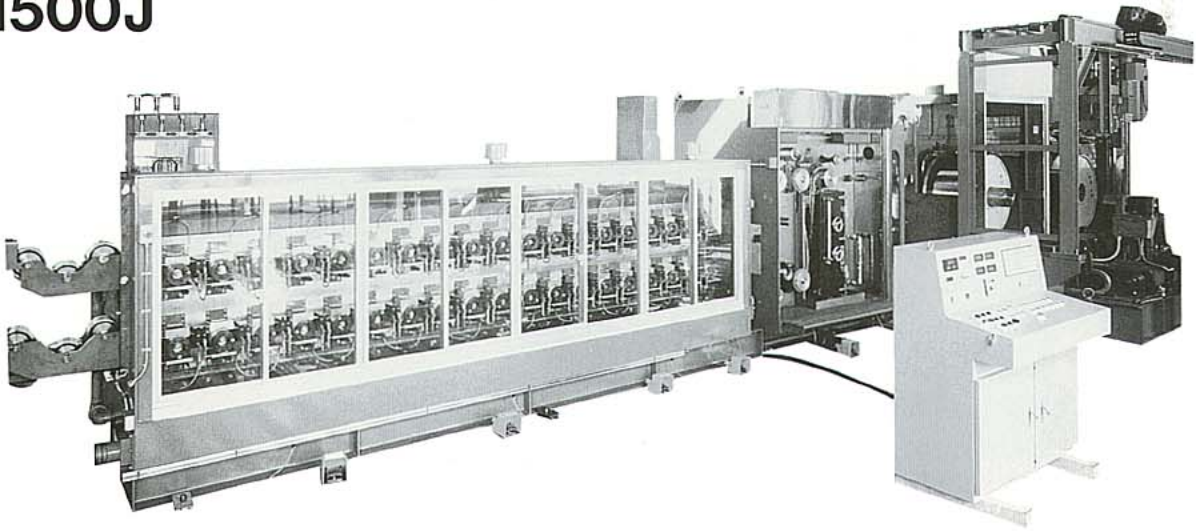

L14000×W6500×H3000

Two-Wires Drawing Machine
with Annealer
(Tow-Spooler Type)

**M20×2+AM0×2
+S100×2**

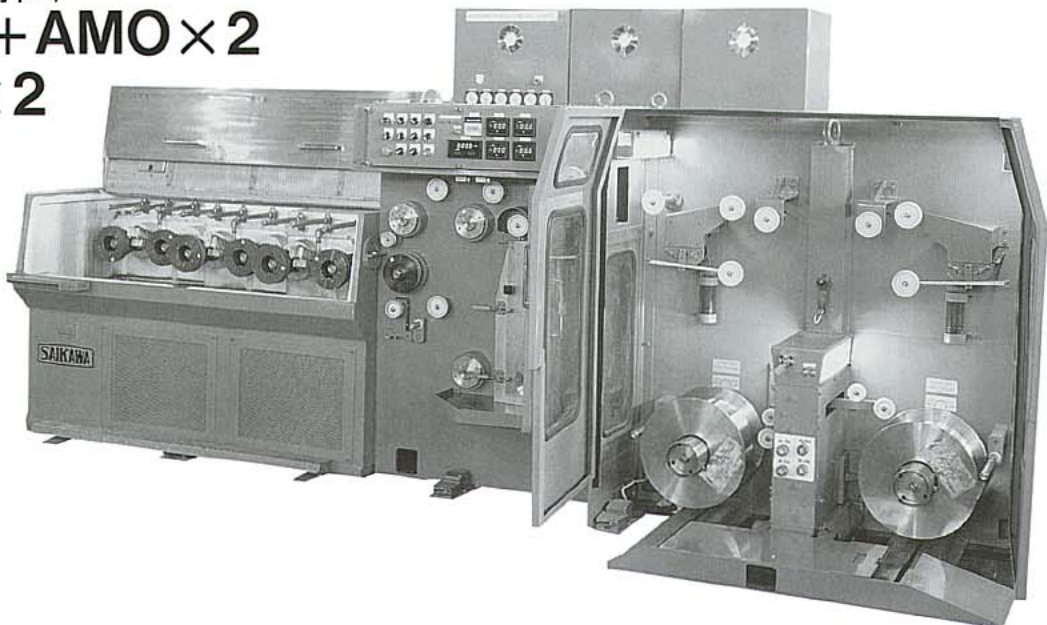

L5000×W1800×H1550

Model	供給線径 Inlet Wire φ m/m	仕上り線径 Finished Wire φ m/m	ボビン容量 Bobbin Capacity kgf
ML24×10+AO X10+R600J	2.6 (0.102in)	0.32 - 0.18 (0.0126 - 0.007in)	600
CS-500D			500

Multiline 10-Wires Drawing Machine with Automatic Bobbin Exchanger
ML24×10+AO×10+R600J

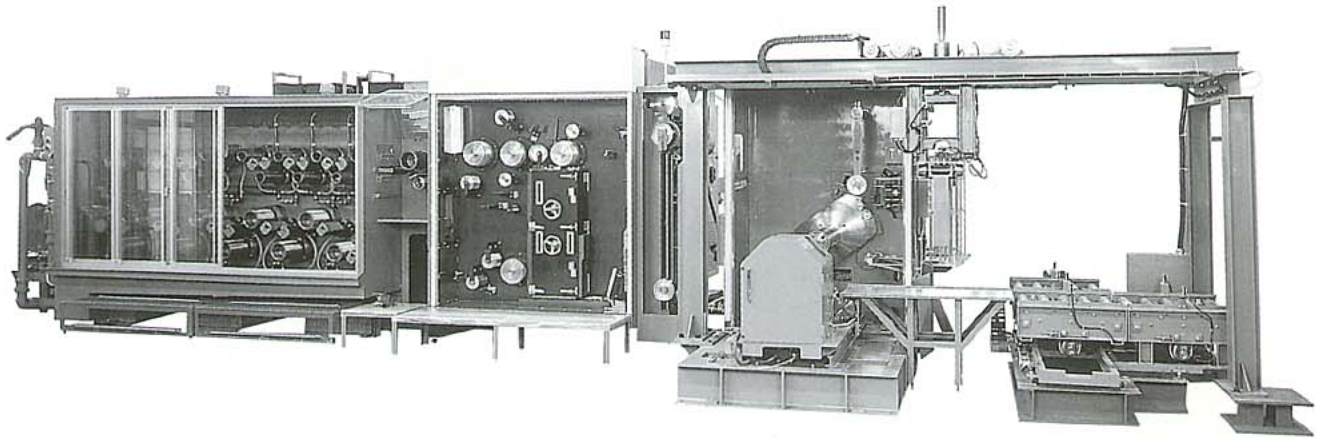

L10520×W3800×H2600

Supply Stand for Multi Wire
CS-500D

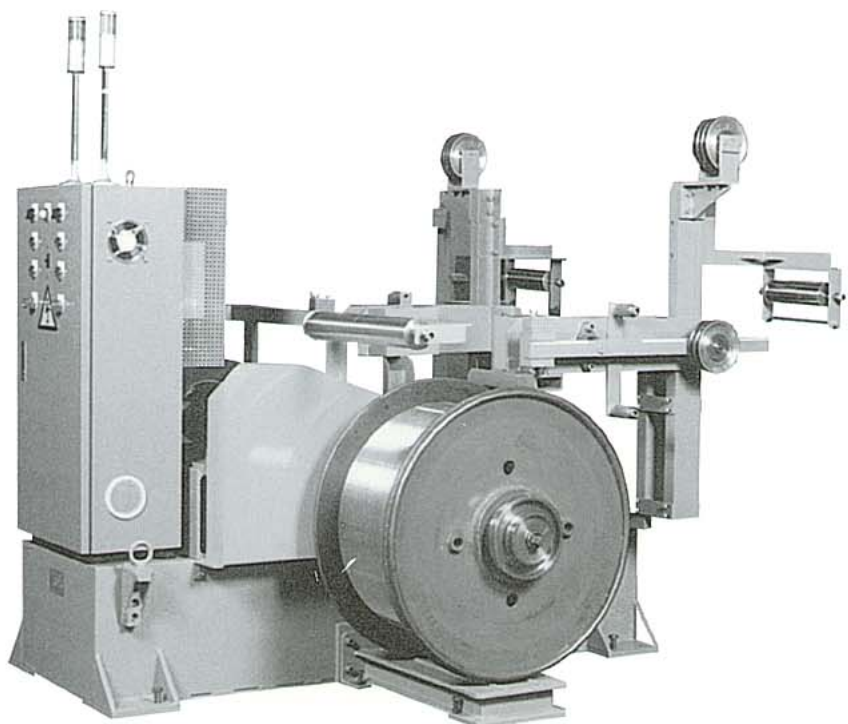

L2300×W2000×H1850

Other Machines

Model	供給線径 Inlet Wire φ m/m	仕上り線径 Finished Wire φ m/m	線径範囲 Wire Dia φ m/m
WSS-9	0.05 - 0.03	0.04 - 0.025	
WS-15	0.15 - 0.04	0.10 - 0.025	
B-2			0.05 - 0.025

Super Fine Drawing Machine for Gold Wire WSS-9



L1100×W1100×H1700

Super Fine Drawing Machine for Aluminum Wire WS-15



L1400×W1150×H1700

2-Head Cross Winding Type Rewinder for Super Fine Wire B-2



L 650×W490×H515

Model	供給線径 Inlet Wire φ m/m	仕上り線径 Finished Wire φ m/m	巻取線径 Wire Dia φ m/m
HMA-21	0.9-0.33	0.3-0.1	
P-5×2			0.8-0.4

Fine Wire Drawing Line Machine for Brass Wire
HMA-21

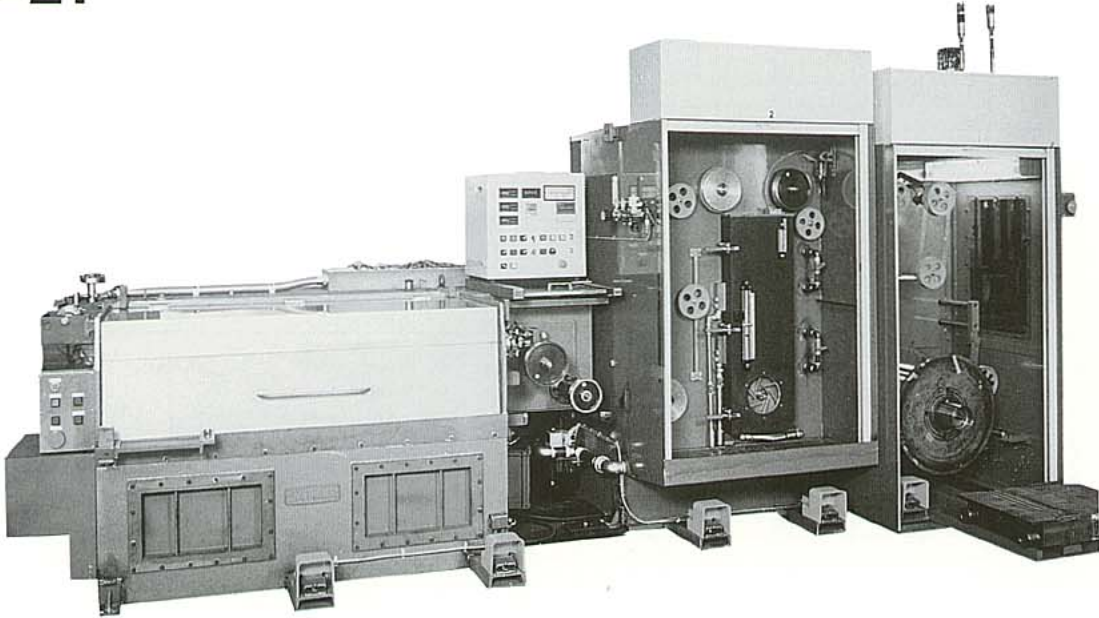

L5000×W3000×H2300

Pail Pack Wind-up Machine
P-5×2



L4000×W1400×H1500

Series of Copper Wire Drawing Machine

Model	Inlet Wire ϕ m/m	Finished Wire ϕ m/m	Number of Die	Max. Speed m/min	Production kgf/Hour	Driving Motor	Winding Capacity kgf	Packing Weight (Gr) app.kgf	Packing Measurement app.M ³
LL-11	9.0	3.2	7	800	3432	250kw/45kw DC-Motor	Max. 2000 (at Coiler) Max. 500 (at Spooler)	54000 (Contain Coiler)	145 (Contain Coiler)
	8.0	2.6	8	1200	3388				
	8.0	2.3	9	1500	3325				
	8.0	2.0	10	1800	3016				
	8.0	1.6	11	1800	1931				
LL-13	8.0	1.4	12	1800	1477				
	8.0	1.2	13	1800	1085				
LA-17D (LA-17S)	3.2	1.2	9	600	362	55kw Inverter Motor + 7.5kw Inverter Motor	250 – 100	21000 (at LA-17D)	69.6 (at LA-17D)
	3.2	1.0	10	600	251				
	2.6	0.9	9	1000	339				
	2.6	0.8	10	1000	268				
	2.6	0.65	12	1500	266				
	2.6	0.6	13	1700	256				
	2.6	0.5	14	2000	210				
	2.6	0.4	16	2000	134				
L-9	3.2	1.2	9	1000	603	55kw Inverter Motor + 5.5kw Inverter Motor	250 – 100	7000	26
	2.6	1.0	8	1300	545				
	2.6	0.9	9	1300	441				
LG-17	3.2	1.2	9	1000	603	55kw Inverter Motor + 7.5kw Inverter Motor	250 – 100	12000	36.2
	3.2	1.0	10	1000	419				
	2.6	0.9	9	1800	611				
	2.6	0.8	10	1800	483				
	2.6	0.6	13	2000	301				
	2.6	0.4	16	2000	134				
	2.0	0.32	16	2000	86				
L-17	3.2	0.9	11	900	305	45kw Inverter Motor + 5.5kw Inverter Motor	250 – 100	7000	26
	3.2	0.8	12	1200	321				
	2.6	0.65	12	1200	212				
	2.6	0.6	13	1500	226				
	2.6	0.5	15	1500	157				
	2.6	0.4	17	1500	101				
L-24	3.2	0.5	17	2000	210	45kw Inverter Motor + 5.5kw Inverter Motor	150 – 50	9200	30.6
	3.2	0.4	19	2000	134				
	2.6	0.32	19	2000	85.8				
	2.6	0.26	21	2000	56.6				
	2.6	0.2	23	2000	33.5				
MH-29J	2.6	0.18	24	2000	27.2	22kw Inverter Motor	100 – 80	6500	22.0
	2.6	0.26	25	2500	70.8				
M-22C (M-22CJ)	2.6	0.18	28	2500	33.9	11kw Inverter Motor + 3.7kw Inverter Motor	100 – 30	3300	10.5
	1.2	0.32	15	1500	64.3				
	1.2	0.26	17	1500	42.5				
	1.2	0.23	18	2000	44.3				
	1.2	0.18	21	2000	27.2				
M-22 (M-22J)	1.2	0.16	22	2000	21.5	7.5kw \times 4p Inverter Motor	60 – 30	2400 (atM-22)	9.72 (atM-22)
	1.0	0.32	13	1500	64.3				
	1.0	0.26	15	1500	42.5				
	1.0	0.23	16	2000	44.3				
	1.0	0.2	18	2000	33.5				
	1.0	0.18	19	2000	27.2				
	1.0	0.16	22	2000	21.5				
	0.9	0.12	22	2000	12.1				
0.6	0.1	20	2000	8.38					
SH-26	0.9	0.12	26	2500	15.1	11kw \times 4p Inverter Motor	50 – 30	4200	12.5
	0.7	0.1	26	2500	10.5				
	0.6	0.08	26	2500	6.70				
	0.5	0.06	26	2500	3.76				
	0.4	0.05	26	2500	2.62				
S-20	0.4	0.1	18	2000	8.38	3.7kw \times 4p Inverter Motor	40 – 20	2300	6.11
	0.32	0.08	18	2000	5.36				
	0.29	0.07	19	2000	4.11				
	0.26	0.06	20	2000	3.01				
	0.18	0.05	17	2000	2.10				
S-20A	0.3	0.08	20	2000	5.36	3.7kw \times 4p Inverter Motor	30 – 10	2300	6.11
	0.26	0.07	20	2000	4.10				
	0.23	0.06	20	2000	3.01				
	0.18	0.05	19	2000	2.09				
	0.15	0.04	20	2000	1.34				
SS-20	0.12	0.05	17	1500	1.57	3.7kw \times 4p Inverter Motor	10 – 2	1700	4.44
	0.08	0.03	20	1500	0.566				
	0.06	0.025	18	1500	0.377				
	0.05	0.02	20	1500	0.252				
US-12	0.04	0.025	12	1000	0.251	0.4kw \times 4p Inverter Motor	5 – 1		1.14
	0.03	0.02	11	1000	0.167				
	0.0224	0.015	11	1000	0.093				
	0.015	0.01	11	1000	0.041				

Standard Bobbins

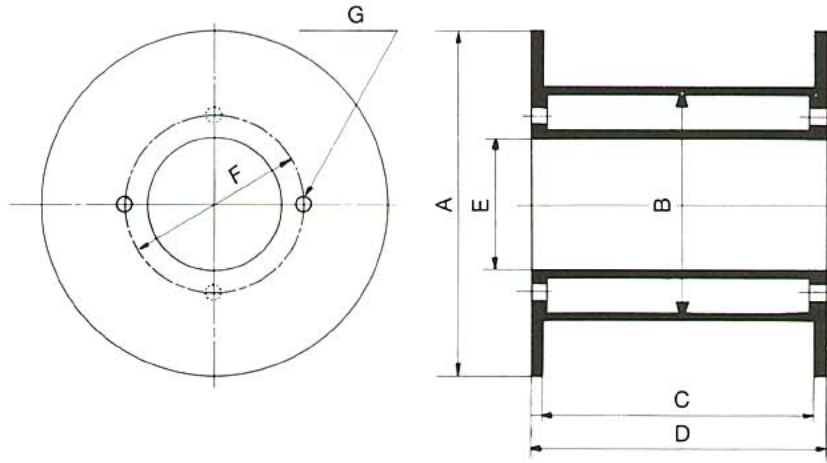

Net Weight Kgf	A	B	C	D	E	F	G	Weight of Bobbin app.Kgf
	ϕ_{m}^{m}	ϕ_{m}^{m}	m_m	m_m	ϕ_{m}^{m}	ϕ_{m}^{m}	ϕ_{m}^{m}	
500	710	402	350	382	152	200	4-20	136.0
250	600	402	350	376	152	200	4-20	89.9
150	450	265	280	304	133	200	4-20	47.9
100	400	265	250	268	133	200	4-20	28.9
60	380	265	250	268	133	200	4-20	32.3
50	300	214	250	268	133	180	4-20	20.0
40	305	214	200	214	133	180	4-20	17.3
30	285	214	200	214	133	180	4-20	16.3

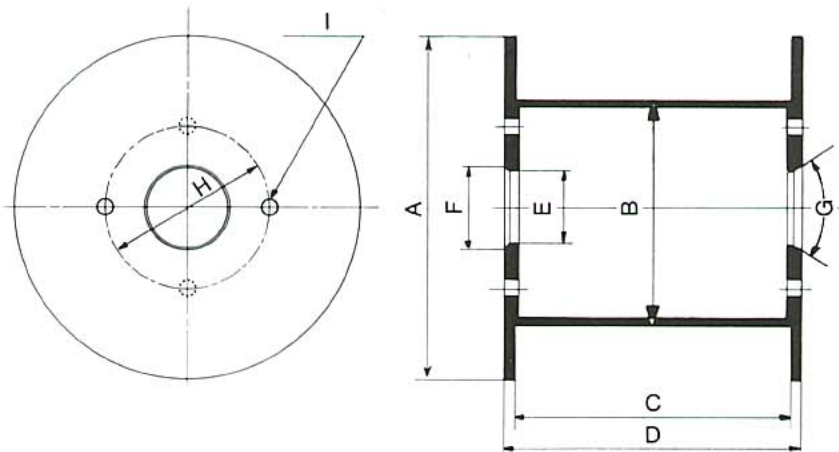

Net Weight Kgf	A	B	C	D	E	F	G	H	I	Weight of Bobbin app.Kgf
	ϕ_{m}^{m}	ϕ_{m}^{m}	m_m	m_m	ϕ_{m}^{m}	ϕ_{m}^{m}	θ°	ϕ_{m}^{m}	ϕ_{m}^{m}	
60	380	265	250	268	100	107	60	180	4-20	30.0
50	300	214	250	268	100	107	60	180	4-20	8.0
40	305	214	200	214	100	107	60	180	4-20	0.7
30	285	214	200	214	100	107	60	180	4-20	8.2
20	225	163	200	212	64	70	60	90	4-11	6.8
15	210	138	150	162	64	70	60	90	4-11	5.2
10	185	138	150	162	64	70	60	90	4-11	5.0
6.0	152	112.7	140	152	43.5	48	60	—	—	3.1
5.0	148	112.7	140	152	43.5	48	60	—	—	
3.0	116	87.5	110	122	43.5	48	60	—	—	
1.0	85	60	85	100	35	39	60	—	—	
0.5	80	60	60	70	20	24	60	—	—	
⊕DP-15K	200	160	180	216	80					(A.B.S)
⊕DP-5	145	110	150	176	70					(A.B.S)

主要製品

- ・銅線用伸線機
- ・アルミ線用伸線機
- ・鋼線及びステンレス線用伸線機
- ・合金及び特殊線用伸線機
- ・逆張力式伸線機
- ・コイラー
- ・ペイル巻取機
- ・通電式連続焼鈍機
- ・冷間ロール成形機
- ・連続抽伸機
- ・ボビン自動着脱装置
- ・無人化ボビン搬送システム
- ・各種塑性加工機械及び電線製造機械
- ・鉄骨、鉄槽、圧力容器その他製缶工事一式

Main Products

- Copper Wire Drawing Machine
- Aluminum Wire Drawing Machine
- Steel and Stainless Wire Drawing Machine
- Other Wire Drawing Machine
- Back Tention System Drawing Machine
- Coiler
- Pail Pack Wind-up Machine
- Electro Resistance Annealing Machine
- Cold Roll Foming Machine
- Combined Machine
- Automatic Exchange System of Spool
- Bobbin Transfer System
- Design and Manufacture of Machine
- Steel Frames, Steel Tanks, Pressure Vessels, Cranes and Others

SAIKAWA

株式会社 **サイカワ**

本社 〒945-1395 新潟県柏崎市安田田尻工業団地7586 TEL 0257-24-4111 番
FAX 0257-23-1361 番

<http://www.saikawa.co.jp/>